

Ergonomic Height Adjustable Desk Solutions

SUNDeSK®

sundeskventure.com



SUNDeSK[®]

Innovative is how we describe ourselves. We began by providing tools fabrication and metal components supplies to automotive and electronic industries across the world. We believe we can be better with our experience and facilities. Our continuous effort and consistently investment in metal fabrication has bring us to manufacture our own product that helps to improve ergonomic and health at workspaces, hospitals and homes.



VISION

Being a diligent and reliable manufacturer that provides steel fabrication and technology solutions with highest quality service, rapid responds and sustainable to our esteemed customers.

MISSION

Committing to our resources and deliver ideal solutions to customers. We ensure to provide sustainable and healthier environment with our well designed and engineered products.

RECOGNITION

The passion, dedication and innovative in our team have helped to improve thousands of work and living spaces across the world with our ergonomic height adjustable desk frame. We believe our solutions has benefit our customer to be healthier and productive.

SUNDeSK®

With more than 10 years in elevating work and living spaces, Sundesk has gained its reputation in manufacturing high quality height adjustable desk frame, as well as customize metal fabrication solutions across the world. Alongside with the growing, we are investing in advance machinery in order to be competitive and keep up with the times.

WHY US

As a one stop metal manufacturer, we have our own facilities to support the fabrication process. We design and build majority of the components in house.

With the collaborative efforts from our innovative designers, experienced engineers and a team of ambitious production has brought us today with a successful range of height adjustable desk frame.

OUR MOVES

We will working on and putting efforts to improve our height adjustable desk frames in terms of quality and functionality. At the same time, we will continuous research and develop the possibilities of being one of the leading metal fabrication manufacturer.

SUNDESK-WHY CHOOSE US



ONE-STOP METAL MANUFACTURING

Our group of companies is fully equipped with metal fabrication facilities. We provide contract manufacturing services across automotive, electronic and automation industries.



CUSTOMIZATION

With the advantages of the facilities, we can provide customization on top of our standard products. We may bespoke our design, sizes and other features to meet customers' requirements.



QUALITY ASSURANCE

SUNDESK set up a team to focus and pay attention in our product quality. The team focuses on research, development and design adjustable frames with best resources and high production standards. SUNDESK products provide up to 5 Years Warranty.



IN HOUSE INNOVATIVE

SUNDESK has the advantages of working with expertise under the group of companies. Our R&D and Engineers are well trained and experienced. Each and every piece of frame components are designed in house. Metal tooling and plastic mould are also designed and fabricated in our factory.



PRODUCTION CAPABILITIES

We believe two hands are better than one. We also work with well known and audited vendors for some manufacturing processes. This helps us to ensure our orders are delivered on time to our customers across the world with fast growing production scale.



GLOBAL NETWORKING

SUNDESK works with numerous partnerships and customers across the world. Since 2015, SUNDESK has set up a warehouse and office in Europe to provide prompt responses to our customers. SUNDESK is well known with the fast-acting support which gained confidence and reputation across the customers worldwide.



CORPORATE SOCIAL RESPONSIBILITY

A river never forgets its source. SUNDESK takes its responsibility in CSR that includes social, employee benefits, tax and also environment. SUNDESK is always feeling grateful and give back to society within our capability.

STRAIGHT-DESK SERIES



Electric Straight Desk - Dual Motor

SD201

1 STAGE/ 2 TIERS



Electric Straight Desk Frame Table | Dual Motor

Height (mm)	min. 695 / max. 1125
Stroke (mm)	430
Frame Length (mm)	min. 1160 / max. 1760
Dynamic Weight Capacity (kg)	120
Frame Weight (kg)	~27.2
Carton Size	L95.2 x W27.5 x H13.3 (cm)
Pallet Size (28 sets)	L110 x W90 x H107 (cm)

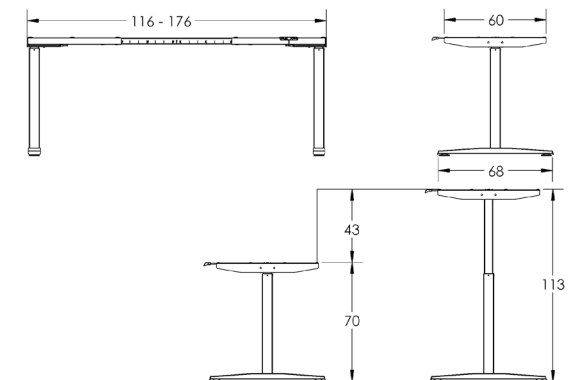

SD301

2 STAGES/ 3 TIERS



Electric Straight Desk Frame Table | Dual Motor

Height (mm)	min. 595 / max. 1235
Stroke (mm)	640
Frame Length (mm)	min. 1160 / max. 1760
Dynamic Weight Capacity (kg)	120
Frame Weight (kg)	~30
Carton Size	L95.2 x W27.5 x H13.3 (cm)
Pallet Size (28 sets)	L110 x W90 x H107 (cm)

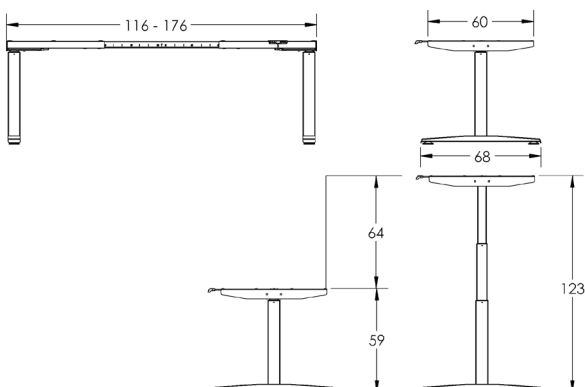

ELECTRIC STRAIGHT DESK - Ecom Version

SD201-S16

1 STAGE/ 2 TIERS



Electric Straight Desk Frame Table | Dual Motor Integrated

Height (mm)	min. 695 / max. 1125
Stroke (mm)	430
Frame Length (mm)	min. 1160 / max. 1760
Dynamic Weight Capacity (kg)	90
Frame Weight (kg)	~27.2
Carton Size	L95.2 x W27.5 x H13.3 (cm)
Pallet Size (28 sets)	L110 x W90 x H107 (cm)

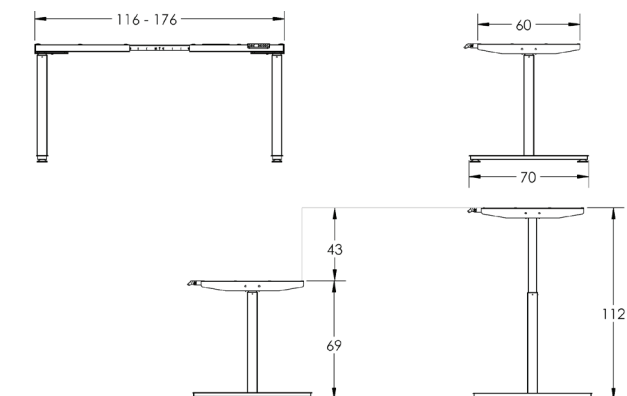

SD234

1 STAGE/ 2 TIERS



Electric Straight Desk Frame Table | Single Motor Integrated

Height (mm)	min. 695 / max. 1125
Stroke (mm)	430
Frame Length (mm)	min. 1160 / max. 1760
Dynamic Weight Capacity (kg)	70
Frame Weight (kg)	~30
Carton Size	L95.2 x W27.5 x H13.3 (cm)
Pallet Size (28 sets)	L110 x W90 x H107 (cm)

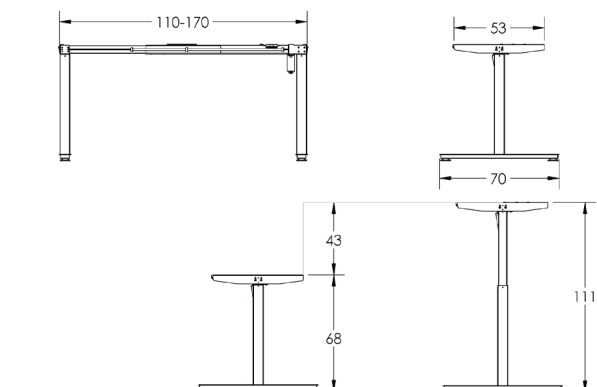

ELECTRIC FRAME - Conversion System

SD234-FF01

1 STAGE / 2 TIERS



Electric Height Adjustable Desk Frame | Training Table

Height (mm)	min. 695 / max. 1125
Stroke (mm)	430
Frame Length (mm)	min. 1160 / max. 1760
Dynamic Weight Capacity (kg)	120
Frame Weight (kg)	~27.2
Carton Size	Powder Coated Steel (RoHS)

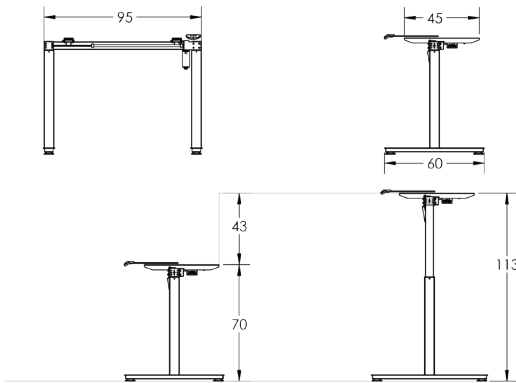

SDTV04-01

2 STAGES / 3 TIERS

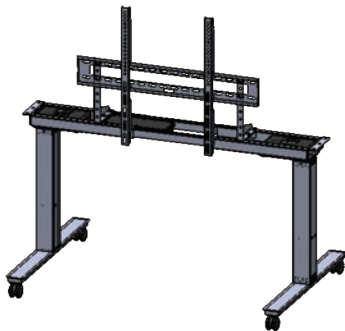

Electric Height Adjustable Frame | Screen Support 50-80 Inch

Height (mm)	min. 820 / max. 1460
Stroke (mm)	640
Frame Length (mm)	min. 885 / max. 1150
Dynamic Weight Capacity (kg)	60
Frame Weight (kg)	32
Carton Size	L112 x W17.5 x H25(cm)
Pallet Size (24 Units)	L112 x W105 x H112(cm)

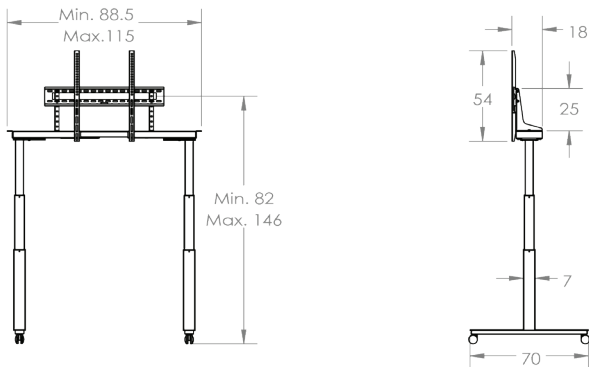

EXECUTIVE SERIES (2-TIERS)



EXECUTIVE 4 LEGS DESK (2 TIERS)

SD207-H

1 STAGE/ 2 TIERS



Electric Executive Desk Frame | H Foot

Height (mm)	min. 695 / max. 1125
Stroke (mm)	430
Frame Length (mm)	(1450-1950) x W900
Dynamic Weight Capacity (kg)	150
Frame Weight (kg)	~43
Carton Size (2 Boxes)	L96.2 x W25.3 x H10.8 (cm)
Pallet Size (18 units)	L110 x W90 x H110 (cm)

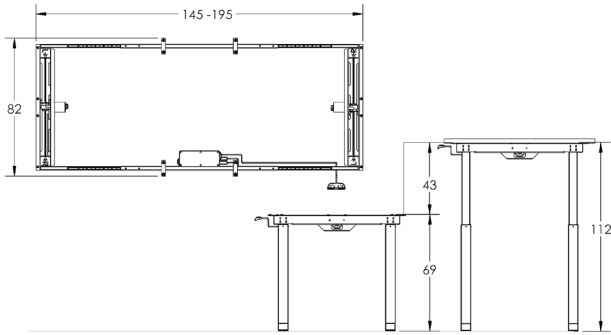

SD207-U

1 STAGE/ 2 TIERS



Electric Executive Desk Frame | U Foot

Height (mm)	min. 695 / max. 1125
Stroke (mm)	430
Frame Length (mm)	(1450-1950) x W900
Dynamic Weight Capacity (kg)	150
Frame Weight (kg)	~44
Carton Size (2 Boxes)	L96.2 x W25.3 x H10.8 (cm)
Pallet Size (18 units)	L110 x W90 x H110 (cm)

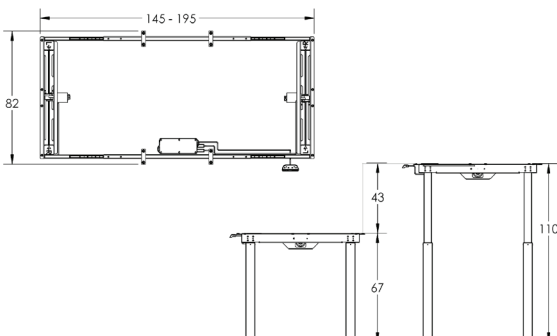

EXECUTIVE MEETING SERIES (3-TIERS)



EXECUTIVE 4 LEGS DESK (3 TIERS)

SD307-H

2 STAGES/ 3 TIERS



Electric Executive Desk Frame | H Foot

Height (mm)	min. 595 / max. 1235
Stroke (mm)	640
Frame Length (mm)	(1450-1950) x W800
Dynamic Weight Capacity (kg)	150
Frame Weight (kg)	~45
Carton Size (2 Boxes)	L96.2 x W25.3 x H10.8 (cm)
Pallet Size (18 units)	L110 x W90 x H110 (cm)

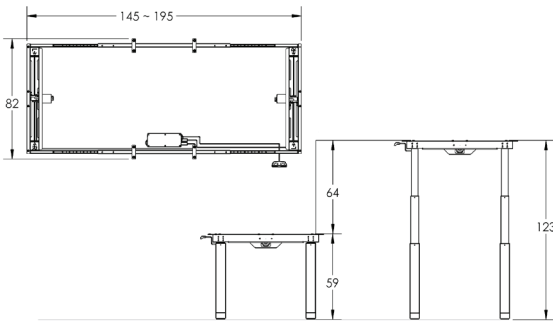

SD307-U

2 STAGES/ 3 TIERS



Electric Executive Desk Frame | U Foot

Height (mm)	min. 595 / max. 1235
Stroke (mm)	640
Frame Length (mm)	(1450-1950) x W800
Dynamic Weight Capacity (kg)	150
Frame Weight (kg)	~44
Carton Size (2 Boxes)	L96.2 x W25.3 x H10.8 (cm)
Pallet Size (18 units)	L110 x W90 x H110 (cm)

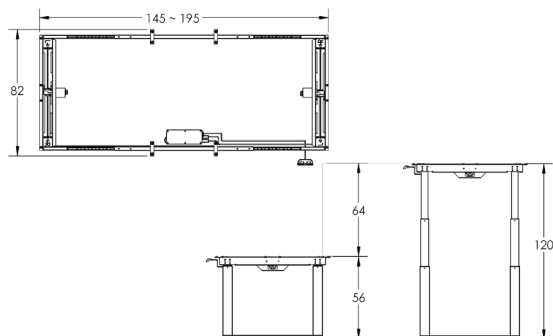

ELECTRIC L SHAPE DESK



ELECTRIC L SHAPE DESK

SD210

1 STAGE/ 2 TIERS



Electric L-Shaped Desk Frame | Triple Motor

Height (mm)	min. 695 / max. 1125
Stroke (mm)	430
Frame Length (mm)	min. 1460/ max. 1750
Dynamic Weight Capacity (kg)	150
Frame Weight (kg)	~41
Carton Size (Box 1)	L111.2 x W17.4 x H25(cm)
Carton Size (Box 2)	L93.3 x W17.2 x H25 (cm)
Pallet Size (10 units)	L111.2 x W90 x H110.6(cm)

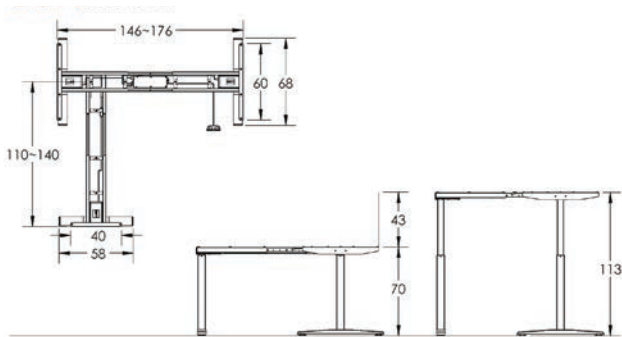

SD310

2 STAGES/ 3 TIERS



Electric L-Shaped Desk Frame | Triple Motor

Height (mm)	min. 595 / max. 1235
Stroke (mm)	640
Frame Length (mm)	min. 1460/ max. 1760
Dynamic Weight Capacity (kg)	150
Frame Weight (kg)	~45
Carton Size (Box 1)	L111.2 x W17.4 x H25(cm)
Carton Size (Box 2)	L93.3 x W17.2 x H25 (cm)
Pallet Size (10 units)	L111.2 x W90 x H110.6(cm)

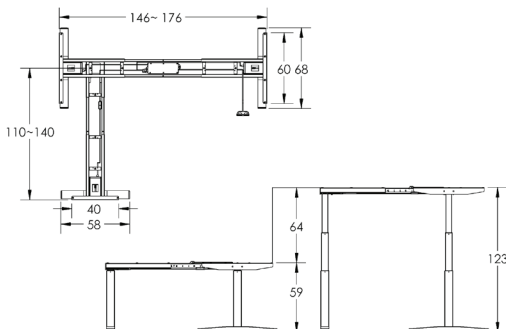

ELECTRIC V SHAPE DESK

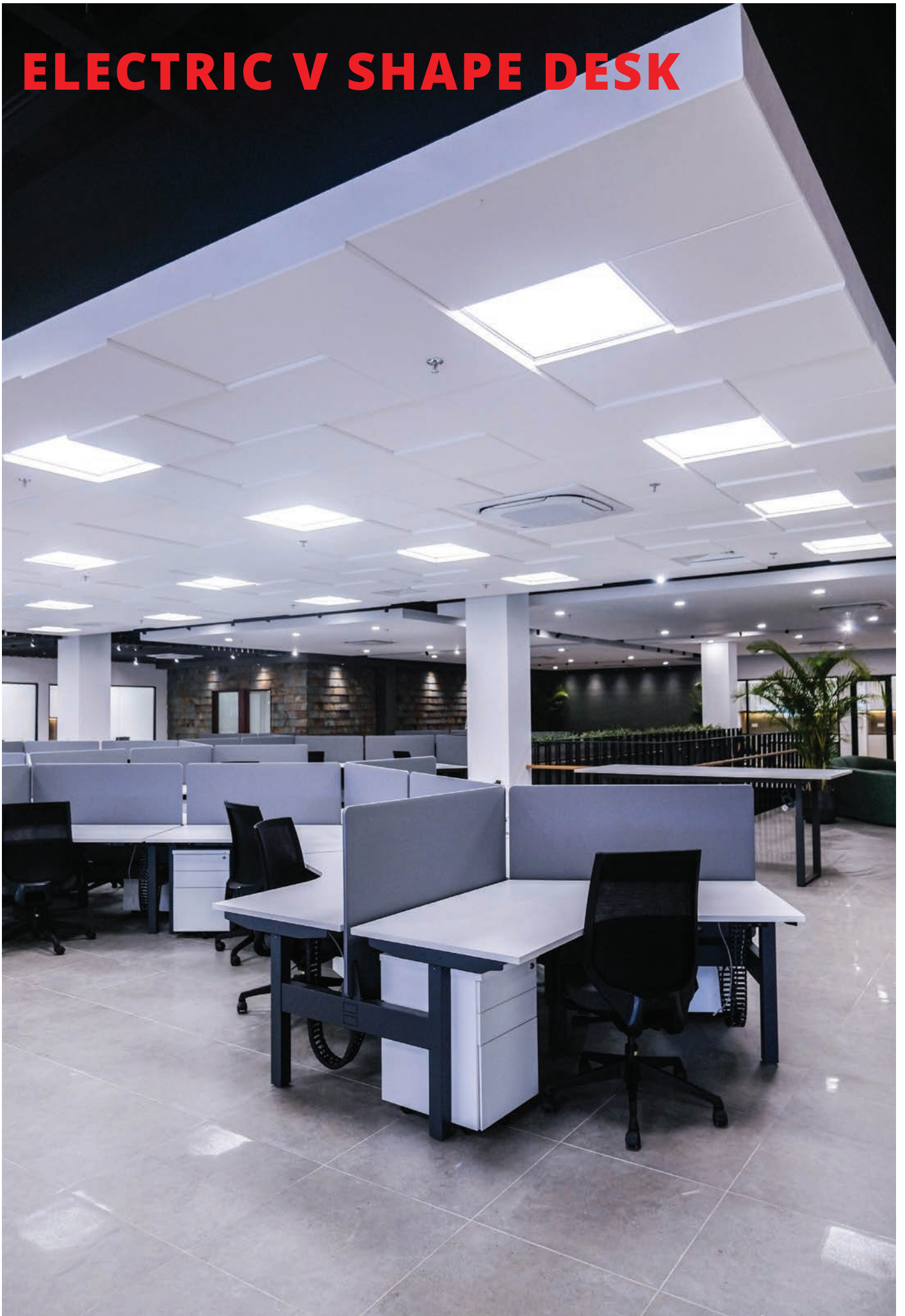

ELECTRIC V SHAPE DESK

SD214

1 STAGE/ 2 TIERS

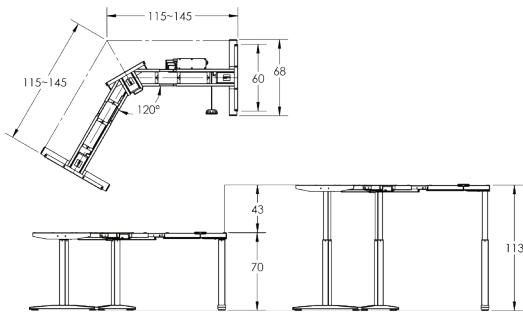

Electric V-Shaped Desk Frame | Triple Motor

Height (mm)	min. 695 / max. 1125
Stroke (mm)	430
Frame Length (mm)	min. 1150/ max. 1450
Dynamic Weight Capacity (kg)	150
Frame Weight (kg)	~42
Carton Size(Box 1)	L111.2 x W17.4 x H25 (cm)
Carton Size (Box 2)	L95 x W17.2 x H21 (cm)
Pallet Size	L112 x W90 x H111 (cm)

SD314

2 STAGES/ 3 TIERS

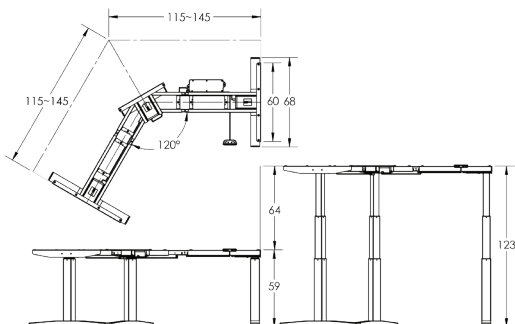

Electric V-Shaped Desk Frame | Triple Motor

Height (mm)	min. 595 / max. 1235
Stroke (mm)	64
Frame Length (mm)	min. 1460/ max. 1760
Dynamic Weight Capacity (kg)	150
Frame Weight (kg)	~45
Carton Size(Box 1)	L111.2 x W17.4 x H25 (cm)
Carton Size (Box 2)	L95 x W17.2 x H21 (cm)
Pallet Size	L112 x W90 x H111 (cm)

BENCHING SERIES



DUAL MOTOR BENCHING SERIES (2 TIERS)

SD204-T

1 STAGE/ 2 TIERS



Electric Double Bench Frame | Dual Motor T Leg

Height (mm)	min. 695 / max. 1125
Stroke (mm)	430
Frame Length (mm)	min. 1160/ max. 1760
Dynamic Weight Capacity (kg)	120
Frame Weight (kg)	~58
Carton Size (2 Boxes)	L112 x W17.5 x H25 (cm)
Pallet Size (12 sets)	L112 x W105 x H112 (cm)

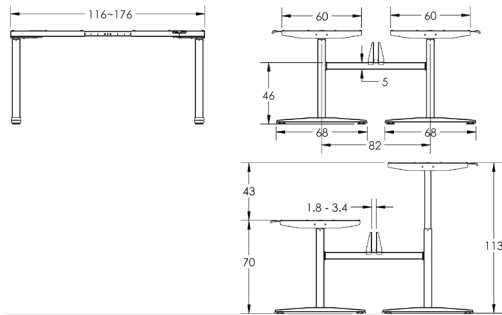

SD204-U

1 STAGE/ 2 TIERS

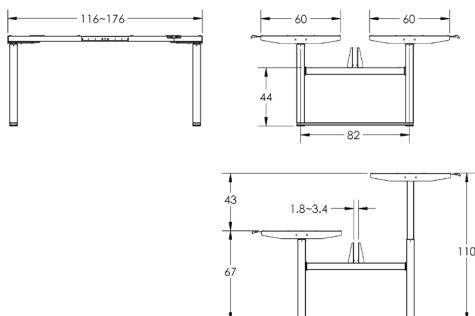

SD204-H

1 STAGE/ 2 TIERS

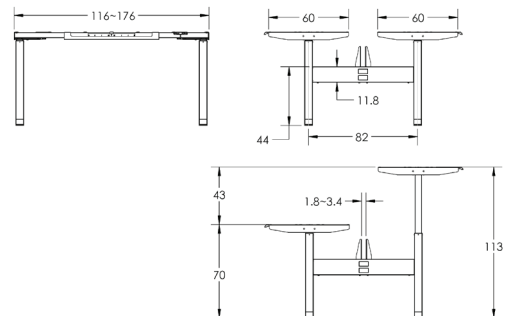

BENCHING SERIES



DUAL MOTOR BENCHING SERIES (3 TIERS)

SD304-T-DM

2 STAGES/ 3 TIERS



Electric 3 Tiers Double Bench Frame | Dual Motor T Leg

Height (mm)	min. 595 / max. 1235
Stroke (mm)	640
Frame Length (mm)	min. 1160/ max. 1760
Dynamic Weight Capacity (kg)	120
Frame Weight (kg)	~64
Carton Size (2 Boxes)	L112 x W17.5 x H25 (cm)
Pallet Size (12 sets)	L112 x W105 x H112 (cm)

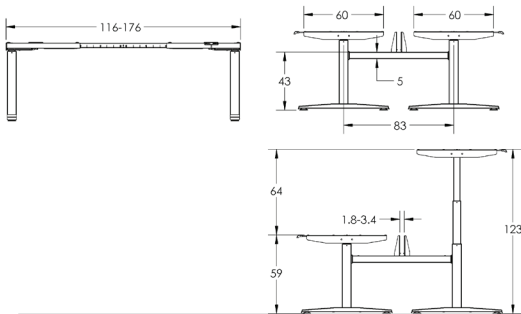

SD304-U-DM

2 STAGES/ 3 TIERS



SD304-H-DM

2 STAGES/ 3 TIERS

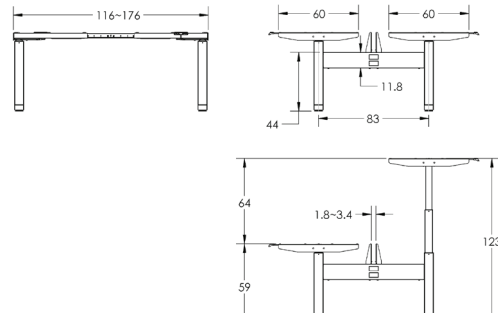
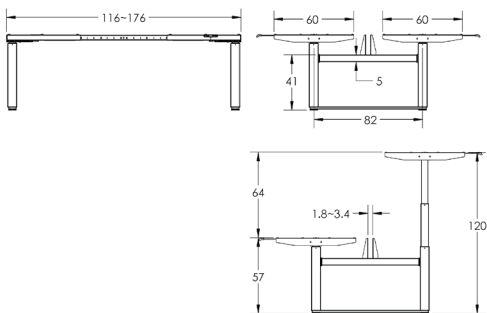

SINGLE COLUMN SERIES



ELECTRIC SINGLE COLUMN

SD227-01

1 STAGE/ 2 TIERS



Single Column Desk Frame | Coffee Table

Height (mm)	min. 695 / max. 1125
Stroke (mm)	430
Top Diameter (mm)	min. 600/ max. 900
Dynamic Weight Capacity (kg)	70
Frame Weight (kg)	~13
Carton Size (Box 1)	L57.5 x W56.5 x H5.4 (cm)
Carton Size (Box 2)	L67.8 x W21.8 x H18.5 (cm)
Pallet Size (16 sets)	L115 x W113 x H107.6 (cm)

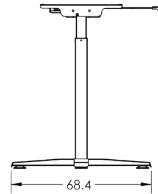
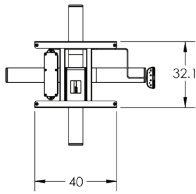

SD227-05

1 STAGE/ 2 TIERS



Electric Height Adjustable Desk Frame | Single Column

Height (mm)	min. 660 / max. 1090
Stroke (mm)	430
Frame Length (mm)	min. 700x450/ max. 800x500
Dynamic Weight Capacity (kg)	60
Frame Weight (kg)	~16
Carton Size (Box 1)	L x W x H (cm)
Carton Size (Box 2)	L x W x H (cm)
Pallet Size (16 sets)	L x W x H (cm)

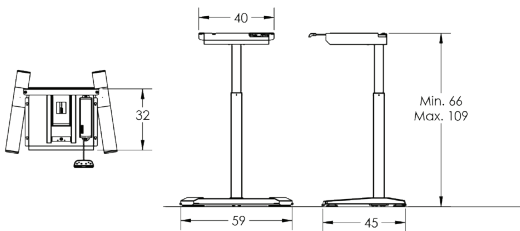

ELECTRIC SINGLE COLUMN

SD227-04

1 STAGE/ 2 TIERS



Single Column Desk Frame | Wall Mounted ; Pods

Height (mm)	min. 750 / max. 1180
Stroke (mm)	430
Frame Length (mm)	min. 700x450 / max. 800x500
Dynamic Weight Capacity (kg)	60
Frame Weight (kg)	~8.4
Carton Size	L67.8 x W21.8 x H18.5 (cm)
Pallet Size (16 sets)	L115 x W113 x H107.6 (cm)

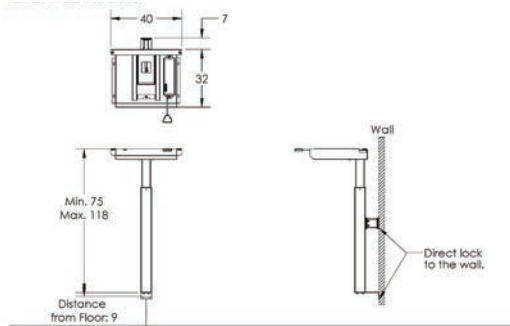

SD227-17

1 STAGE/ 2 TIERS



Single Column Desk Frame | Wall Mounted ; Pods

Height (mm)	min. 670 / max. 1110
Stroke (mm)	430
Frame Length (mm)	650x450
Dynamic Weight Capacity (kg)	60
Frame Weight (kg)	~13
Carton Size	L67.8 x W21.8 x H18.5 (cm)
Pallet Size (16 sets)	L115 x W113 x H107.6 (cm)

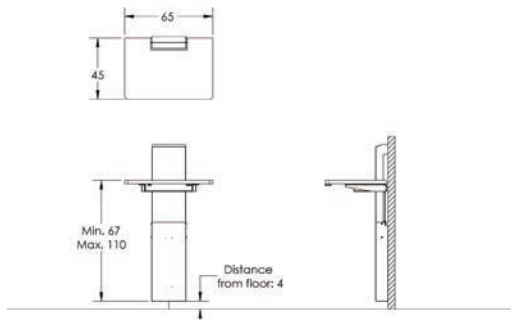

ELECTRIC SINGLE COLUMN

SD227-TATAMI

1 STAGE/ 2 TIERS



Single Column Desk Frame | Sit to Sit Tatami

Height (mm)	min. 560 / max. 860
Stroke (mm)	300
Desktop Size (Recommend)	1200x750
Dynamic Weight Capacity (kg)	80
Frame Weight (kg)	~28
Carton Size	L x W x H (cm)
Pallet Size (16 sets)	L x W x H (cm)

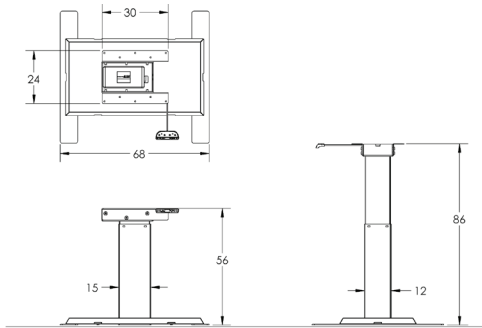

SD277-EXECUTIVE

1 STAGE/ 2 TIERS

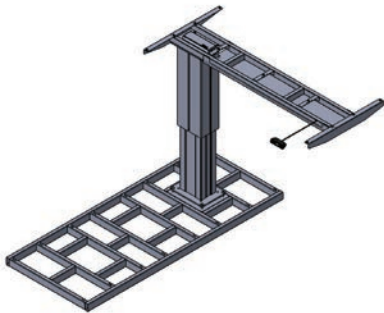

Electric Height Adjustable Desk Frame | Director

Height (mm)	min. 595 / max. 1235
Stroke (mm)	640
Desktop Size	2000x800mm
Installation Type	With Counter Weight Base
Dynamic Weight Capacity (kg)	80
Frame Weight (kg)	25.5
Carton Size	L x W x H (cm)

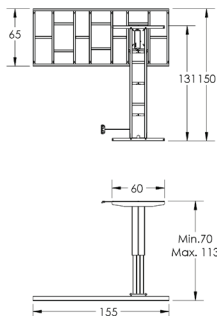

SINGLE MOTOR SERIES



ELECTRIC STRAIGHT DESK (SINGLE MOTOR)

E23T

1 STAGE/ 2 TIERS



Electric Adjustable Desk Frame | Single Motor

Height (mm)	min. 680 / max. 1110
Stroke (mm)	430
Frame Length (mm)	min. 1110/ max. 1700
Dynamic Weight Capacity (kg)	60
Frame Weight (kg)	23.5
Carton Size	L96 x W26 x H11.5 (cm)
Pallet Size (32 sets)	L110 x W90 x H110 (cm)

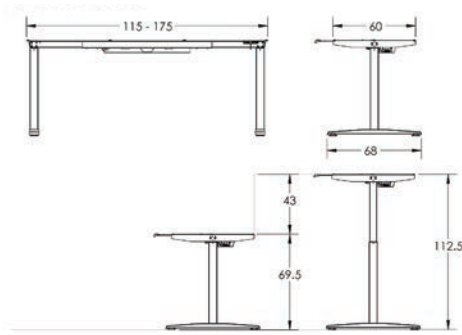

E53T

2 STAGES / 3 TIERS



Manual Adjustable Desk Frame | Single Motor

Height (mm)	min. 595 / max. 1235
Stroke (mm)	640
Frame Length (mm)	min. 1100/ max. 1700
Dynamic Weight Capacity (kg)	60
Frame Weight (kg)	~28.8
Carton Size	L96 x W26 x H11.5 (cm)
Pallet Size (32 sets)	L110 x W90 x H110 (cm)

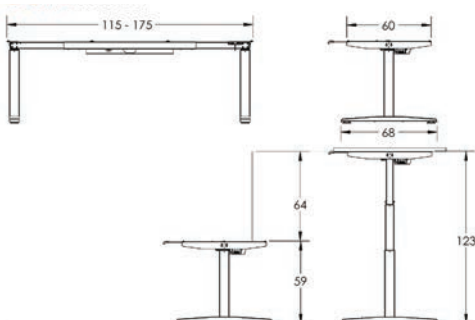

Single Motor 2 Tiers



DSE23TS

1 STAGE/ 2 TIERS

Electric 2 Tier Double Bench Frame | Single Motor T Leg

Height (mm)	min. 690 / max. 1125
Stroke (mm)	430
Frame Length (mm)	min. 1150 / max. 1750
Dynamic Capacity (kg)	80
Weight/Set (kg)	~50
Carton Size (2 Boxes)	L95.2 x W27.5 x H13.3 (cm)
Pallet Size (14 sets)	L110 x W95 x H107 (cm)



DSE25TS

1 STAGE/ 2 TIERS

Electric 2 Tier Double Bench Frame | Single Motor U Leg

Height (mm)	min. 690 / max. 1125
Stroke (mm)	430
Frame Length (mm)	min. 1150 / max. 1750
Dynamic Capacity (kg)	80
Weight/Set (kg)	~50
Carton Size (2 Boxes)	L95.2 x W27.5 x H13.3 (cm)
Pallet Size (14 sets)	L110 x W95 x H107 (cm)



DSE11TS

1 STAGE/ 2 TIERS

Electric 2 Tier Double Bench Frame | Single Motor H Leg

Height (mm)	min. 690 / max. 1125
Stroke (mm)	430
Frame Length (mm)	min. 1150 / max. 1750
Dynamic Capacity (kg)	80
Weight/Set (kg)	~51
Carton Size (2 Boxes)	L95.2 x W27.5 x H13.3 (cm)
Pallet Size (14 sets)	L110 x W95 x H107 (cm)

Single Motor 3 Tiers



SD305-T

2 STAGES/ 3 TIERS

Electric 3 Tier Double Bench Frame | Single Motor T Leg

Height (mm)	min. 595 / max. 1235
Stroke (mm)	640
Frame Length (mm)	min. 1150 / max.1750
Dynamic Capacity (kg)	80
Weight/Set (kg)	~54
Carton Size (2 Boxes)	L95.2 x W27.5 x H13.3 (cm)
Pallet Size (14 sets)	L110 x W95 x H107 (cm)

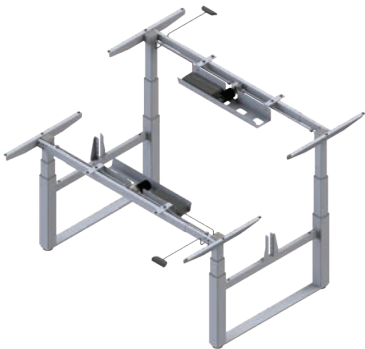

SD305-U

2 STAGES/ 3 TIERS

Electric 3 Tier Double Bench Frame | Single Motor U Leg

Height (mm)	min. 595 / max. 1235
Stroke (mm)	640
Frame Length (mm)	min. 1150 / max.1750
Dynamic Capacity (kg)	80
Weight/Set (kg)	~54
Carton Size (2 Boxes)	L95.2 x W27.5 x H13.3 (cm)
Pallet Size (14 sets)	L110 x W95 x H107 (cm)



SD305-H

2 STAGES/ 3 TIERS

Electric 3 Tier Double Bench Frame | Single Motor H Leg

Height (mm)	min. 595 / max. 1235
Stroke (mm)	640
Frame Length (mm)	min. 1150 / max.1750
Dynamic Capacity (kg)	80
Weight/Set (kg)	~51
Carton Size (2 Boxes)	L95.2 x W27.5 x H13.3 (cm)
Pallet Size (14 sets)	L110 x W95 x H107 (cm)

Manual Eco Crank Series

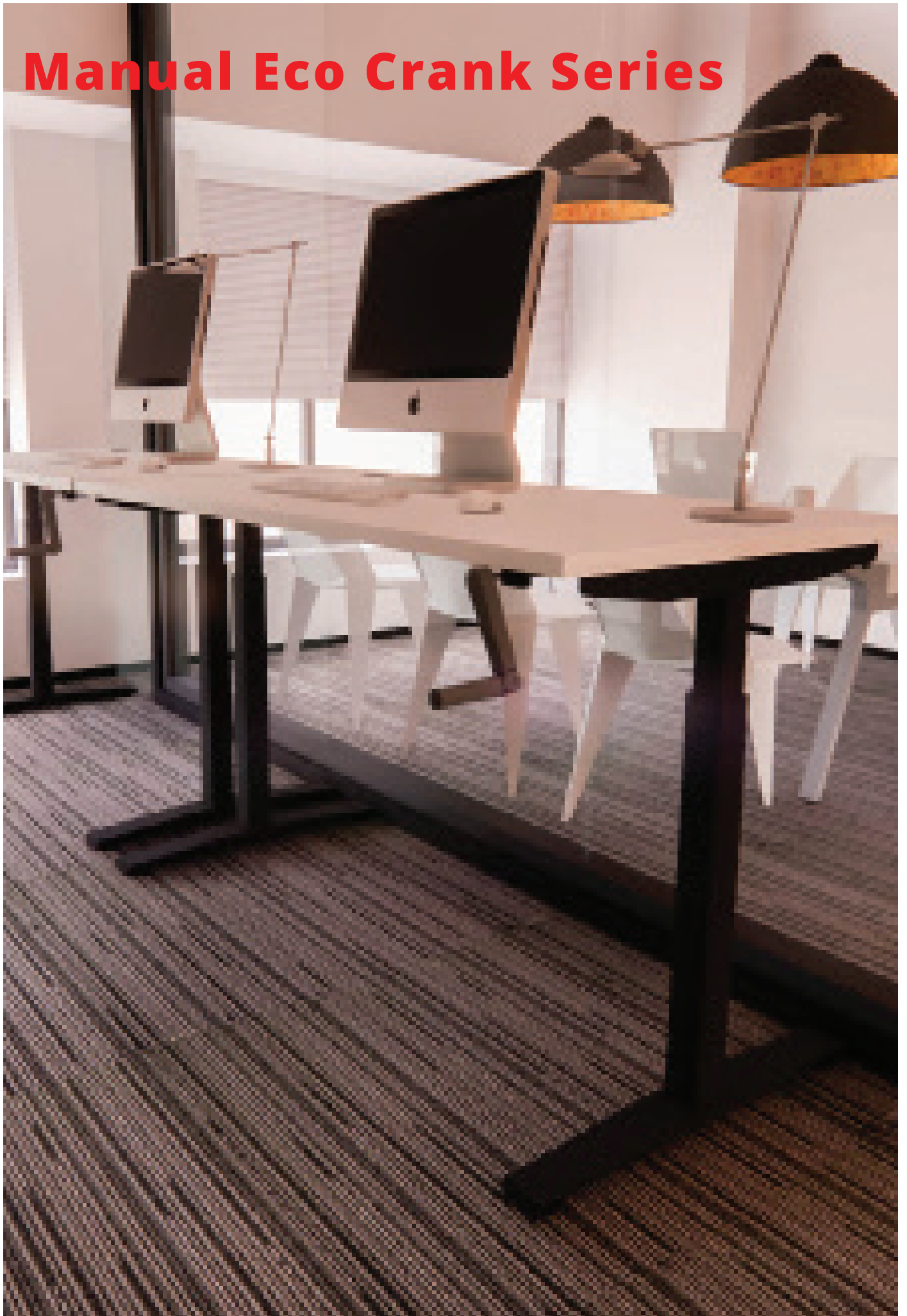

MANUAL CRANK ECO STRAIGHT DESK

H24T

1 STAGE/ 2 TIERS



Manual Height Adjustable Desk Frame | Hand Crank

Height (mm)	min. 690 / max. 1180
Stroke (mm)	490
Frame Length (mm)	min. 1150/ max. 1750
Dynamic Weight Capacity (kg)	80
Frame Weight (kg)	~19.7
Carton Size	L96 x W26 x H11.5 (cm)
Pallet Size (32 sets)	L110 x W90 x H110 (cm)

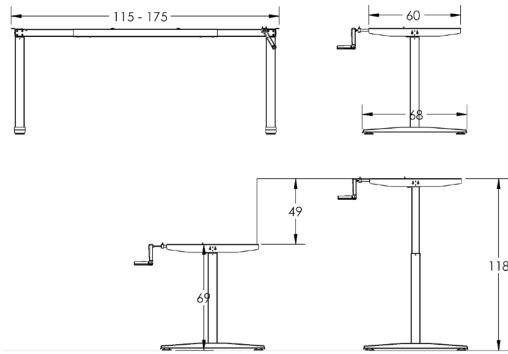

H54T

2 STAGES/ 3 TIERS



Manual Height Adjustable Desk Frame | Hand Crank

Height (mm)	min. 585 / max. 1250
Stroke (mm)	665
Frame Length (mm)	min. 1150/ max. 1750
Dynamic Weight Capacity (kg)	80
Frame Weight (kg)	~22
Carton Size	L96 x W26 x H11.5 (cm)
Pallet Size (32 sets)	L110 x W90 x H110 (cm)

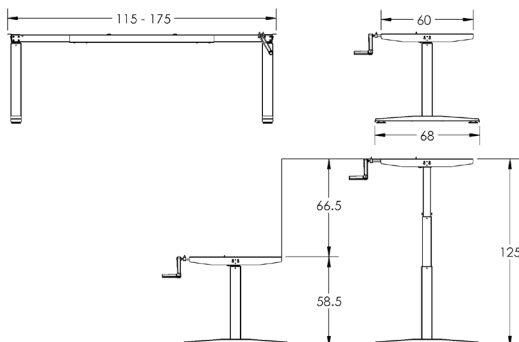

V Shape || L Shape Desk

H26T

1 STAGE/ 2 TIERS



Manual Hand Crank | L-Shaped Desk Frame Left & Right

Height (mm)	min. 690 / max. 1180
Stroke (mm)	490
Frame Length (mm)	min. 1450 / max. 1750
Dynamic Capacity (kg)	80
Weight/Set (kg)	~33.5
Carton Size (Box 1)	L96.2 x W25.3 x H10.8 (cm)
Carton Size (Box 2)	L103.4 x W20.8 x H11.4 (cm)
Pallet Size (16 sets)	L110 x W90 x H101 (cm)

H28T

1 STAGE/ 2 TIERS



Manual Hand Crank | 120 Degree Desk Frame

Height (mm)	min. 690 / max. 1180
Stroke (mm)	490
Frame Length (mm)	min.1150 / max 1450
Dynamic Capacity (kg)	80
Weight/Set (kg)	~30
Carton Size (Box 1)	L96.2 x W25.3 x H10.8 (cm)
Carton Size (Box 2)	L103.4 x W20.8 x H11.4 (cm)
Pallet Size (16 sets)	L110 x W90 x H101 (cm)

H56T

2 STAGES/ 3 TIERS



Manual Hand Crank | L-Shaped Desk Frame Left & Right

Height (mm)	min. 595 / max. 1235
Stroke (mm)	640
Frame Length (mm)	min. 1450 / max. 1750
Dynamic Capacity (kg)	80
Weight/Set (kg)	~37.5
Carton Size (Box 1)	L96.2 x W25.3 x H10.8 (cm)
Carton Size (Box 2)	L103.4 x W20.8 x H11.4 (cm)
Pallet Size (16 sets)	L110 x W90 x H101 (cm)

H58T

2 STAGES/ 3 TIERS



Manual Hand Crank | 120 Degree Desk Frame

Height (mm)	min. 595 / max. 1235
Stroke (cm)	640
Frame Length (mm)	min.1150 / max 1450 X W600
Dynamic Capacity (kg)	80
Weight/Set (kg)	~34.5
Carton Size (Box 1)	L96.2 x W25.3 x H10.8 (cm)
Carton Size (Box 2)	L103.4 x W20.8 x H11.4 (cm)
Pallet Size (16 sets)	L110 x W90 x H101 (cm)

Eco Crank Benching



ST SUPREME DSH24TS

1 STAGE/ 2 TIERS

Manual Double Bench Frame | Manual T Leg

Height (mm)	min. 690 / max. 1180
Stroke (mm)	490
Frame Length (mm)	min. 1150 / max. 1750
Dynamic Capacity (kg)	80
Weight/Set (kg)	~44
Carton Size (2 boxes)	L96 x W26 x H11.5 (cm)
Pallet Size (16 sets)	L110 x W90 x H110 (cm)



ST SUPREME DSH26TS

1 STAGE/ 2 TIERS

Manual Double Bench Frame | Manual U Leg

Height (mm)	min. 690 / max. 1180
Stroke (mm)	490
Frame Length (mm)	min. 1150 / max. 1750
Dynamic Capacity (kg)	80
Weight/Set (kg)	~45
Carton Size (2 boxes)	L96 x W26 x H11.5 (cm)
Pallet Size (16 sets)	L110 x W90 x H110 (cm)



ST SUPREME DSH12TS

1 STAGE/ 2 TIERS

Manual Double Bench Frame | Manual H Leg

Height (cm)	min . 69 / max. 1180
Stroke (cm)	490
Frame Length (cm)	min. 115 / max. 175
Weight/Set (kg)	~41
Carton Size (2 boxes)	L96 x W26 x H11.5 (cm)
Pallet Size (16 sets)	L110 x W90 x H110 (cm)



ACCESSORIES

CT100

Adjustable Cable Tray

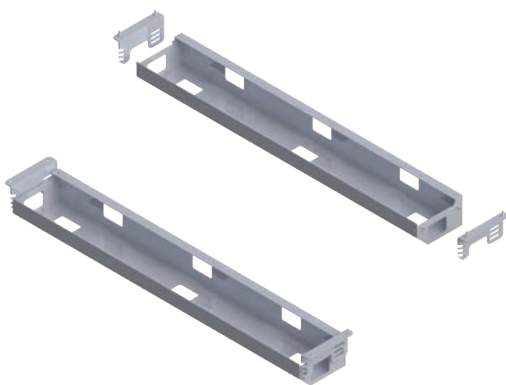

Cable Management | Cable Tray

Dimension (mm)	H1000 X W150
Weight/Set (kg)	~2.8
Features	Adjustable Space
Material Finishing	Powder Coated Steel (RoHS)
Packing Dimension (Set)	L965 x W160 x H110 (cm)

CT133

Universal Cable Tray

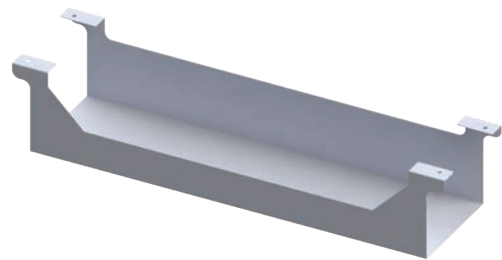

Cable Management | Cable Tray

Dimension (mm)	L600 X W150 X H120
Weight/Set (kg)	~1.2
Features	Universal Tray
Material Finishing	Powder Coated Steel (RoHS)
Packing Dimension (Set)	L612 x W159 x H134 (cm)

CB071

Cable Riser

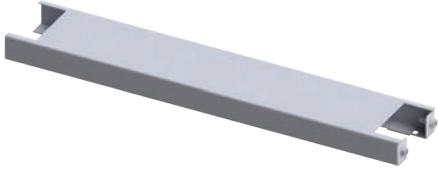

Cable Management | Straight Desk Cable Riser

Dimension (mm)	L63 X W23 X H450
Weight/Set (kg)	~0.6
Features	Improve Cable Management
Material Finishing	Powder Coated Steel (RoHS)
Packing Dimension	L x W x H (cm)

CM1

Cable Skeleton / Cable Snake



Cable Management | Cable Skeleton

Dimension (mm)	L70 X W20 X H1200
Weight/Set (kg)	~0.4
Features	Improve Cable Management
Material Finishing	Nylon PA66
Packing Dimension	L x W x H (cm)

SD-SK01

Cable Trunking Metal



Cable Management | Cable Trunking Metal

Dimension (mm)	L580 x W38
Weight/Set (kg)	~1.6
Adjustable Length (mm)	min 600 ; max 1240
Features	Improve Cable Management
Packing Dimension	L x W x H (cm)

SD-DR01

Storage Drawer

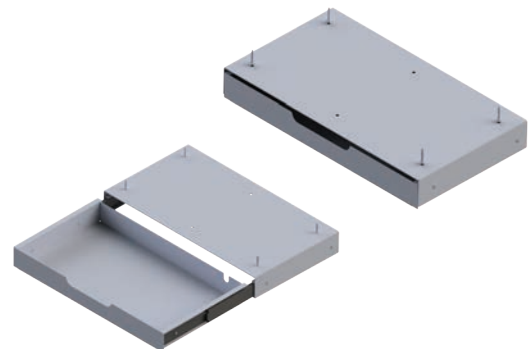

Storage Management | Drawer

Dimension (mm)	L460 X W260 X H60
Weight/Set (kg)	~2.5
Features	Storage
Material Finishing	Powder Coated Steel (RoHS)
Packing Dimension	L x W x H (cm)

SD-MP01

Modesty Panel

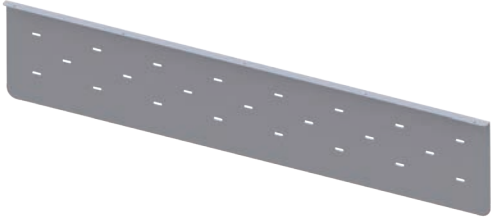

Accessories | Modesty Panel (4ft / 5ft / 6ft)

Dimension (mm)	L1200 X H250
Weight/Set (kg)	~2.2
Features	Improve Privacy
Material Finishing	Powder Coated Steel (RoHS)
Packing Dimension	L x W x H (cm)

SD-PB02

Bracket for Screen Panel



Accessories | Panel Bracket L

Dimension (mm)	L160 X W23 X H280
Weight/Set (kg)	~0.7
Features	To Hold Modesty Panel
Packing Dimension	L x W x H

CB423

Side Crossbar Support



Accessories | Side Crossbar Support

Dimension (mm)	L450 x W51 x H267
Weight/Set (kg)	~2.8
Features	To hold Panel and Tray
Material Finishing	Powder Coated Steel (RoHS)
Packing Dimension	L46 x W6.1 x H12 (cm)

SD-CPH01

CPU Accessories



Accessories | CPU Holder

Height (cm)	min . 435 / max. 527
Lock Point	3
Support Width (cm)	min. 130 / max. 180
Weight/ Set (kg)	~4.5
Packing Dimension	L x W x H (cm)

CB330

Joint Crossbar



Accessories | Benching Crossbar

Dimension (mm)	L897 x W60 x H210
Weight/Set (kg)	~4.6
Features	Integrate Desking System
Material Finishing	Powder Coated Steel (RoHS)
Packing Dimension	L750 x W127 x H68

SD-OP01

Mini Architecture



Accessories | Mini Architecture

Dimension (mm)	L1500 x W300 x H1350
Weight/Set (kg)	~18
Features	Mini Architecture / Shelving
Material Finishing	Powder Coated Steel (RoHS)
Packing Dimension	L X W X H

Power Beam PDB-70

Stand Alone Power Beam



Power & Data Distribution System | Standalone (4ft, 5ft, 6ft)

Dimension (mm)	L900 X W380 X H550
Weight/Set (kg)	~13
Features	Power and Data
Material Finishing	Powder Coated Steel (RoHS)
Packing Dimension (cm)	L112 X W17.5 X H20

SD-PT01

Portable Power Extender



Power & Data Distribution System | Portable

Dimension (mm)	L200 x W150 x H590
Weight/Set (kg)	~2
Features	Power and Data
Material Finishing	Powder Coated Steel (RoHS)
Packing Dimension	L x W x H



CT122

Telescopic Centre Cable Tray for Benching

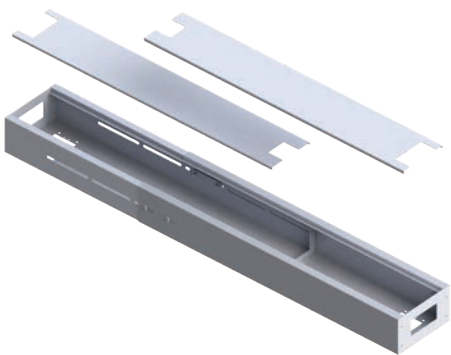

Cable Management | Telescopic Tray (4ft to 6ft)

Dimension (mm)	L1000-1630 x W200 x H110
Weight/Set (kg)	~10
Features	Telescopic for 4ft to 6ft Tops
Material Finishing	Powder Coated Steel (RoHS)
Packing Dimension (cm)	L90 x W21 x H13

CT116

Fix Centre Cable Tray for Benching

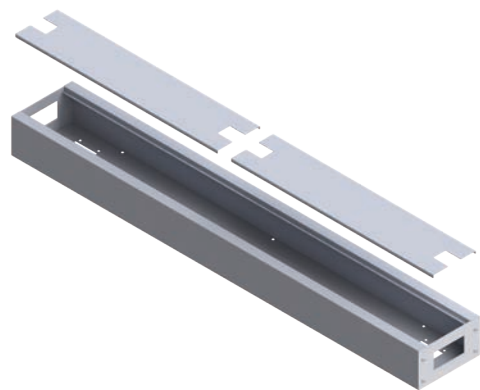

Cable Management | Fix Tray (4ft, 5ft, 6ft)

Dimension 4ft (mm)	L1325 x W200 x H110
Weight/Set (kg)	~7.5
Features	Centre Cable Tray for Benching
Material Finishing	Powder Coated Steel (RoHS)
Packing Dimension 4ft (cm)	L135 x W22 x H13

CB124

Link Bridge

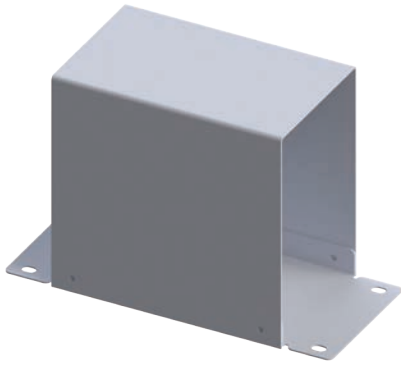

Cable Management | Link Bridge for Benching and Clusters

Dimension (mm)	L174 x W76 x H115
Weight/Set (kg)	~0.6
Features	Cable trunk between 2 clusters
Material Finishing	Powder Coated Steel (RoHS)
Packing Dimension(cm)	L18 x W8.2 x H12.0

CB323

Screen Bracket



Accessories | Screen Bracket for Benching and Clusters

Dimension (mm)	L40 x W31 x H166
Weight/Set (kg)	~0.4
Features	Hold and Clamp Benching Panel
Material Finishing	Powder Coated Steel (RoHS)

CB088

Cable Riser



Cable Management | Cable riser for Benching

Dimension (mm)	L150 x W80 x H323
Weight/Set (kg)	~2.6
Features	Cable riser for bench from floor
Material Finishing	Powder Coated Steel (RoHS)
Packing Dimension(cm)	L35 x W17 x H10

SD-TLB01

Link Bridge Telescopic

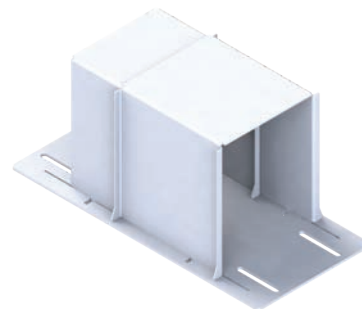

Cable Management | Telescopic Link Bridge

Dimension (mm)	L240 x W110 x H117
Weight/Set (kg)	~1.2
Features	Telescopic Link Bridge
Material Finishing	Powder Coated Steel (RoHS)
Packing Dimension	L260 x W130 x H140



CT111

Cable Tray Telescopic

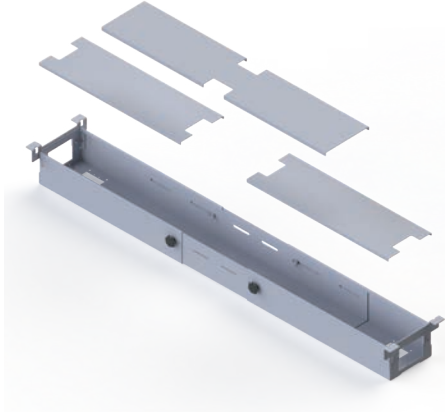

Cable Management | Telescopic Tray (4ft, 5ft, 6ft)

Dimension (mm)	L1740 x W76 x H115
Weight/Set (kg)	~7.0
Features	Telescopic Tray
Material Finishing	Powder Coated Steel (RoHS)
Packing Dimension (cm)	L180 x W8.2 x H12

CB339

Centre Cross Arm



Cable Management | Cable Riser and Crossbar for V Desk

Dimension (mm)	L470 x W470 x H425
Weight/Set (kg)	~0.4
Features	Cable Riser and Support
Material Finishing	Powder Coated Steel (RoHS)
Packing Dimension (cm)	L46 x W27 x H25

CB092

Cable Riser with Link Channel



Cable Management | Cable Riser Link Channel

Dimension (mm)	L122 x W100 x H440
Weight/Set (kg)	~3.6
Features	Cable Riser with Link Channel
Material Finishing	Powder Coated Steel (RoHS)
Packing Dimension (cm)	L46 x W14 x H12

CB173A

Side Crossbar

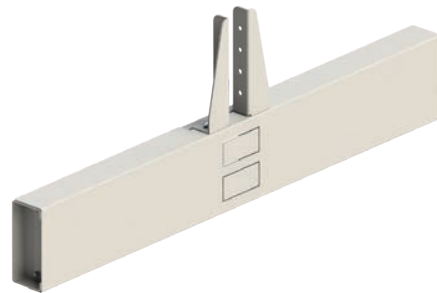

Accessories | Side Crossbar to integrate system

Dimension (mm)	L x W x H
Weight/Set (kg)	~9.2
Features	Cable riser with link channel
Material Finishing	Powder Coated Steel (RoHS)
Packing Dimension (cm)	L x W x H

FIX STRAIGHT DESK FRAME

T24T

1 STAGE/ 2 TIERS



Screw Type Height Adjustable Frame | Technician Desk

Height (mm)	min. 690 / max. 790
Stroke (mm)	100
Frame Length (mm)	min. 1150/ max. 1750
Dynamic Weight Capacity (kg)	150
Frame Weight (kg)	~16.5
Carton Size (cm)	L96.2 x 25.3 x H10.8
Pallet Size (cm)	L110 x W90 x H110
Carton Size (cm)	L96.2 x 25.3 x H10.8

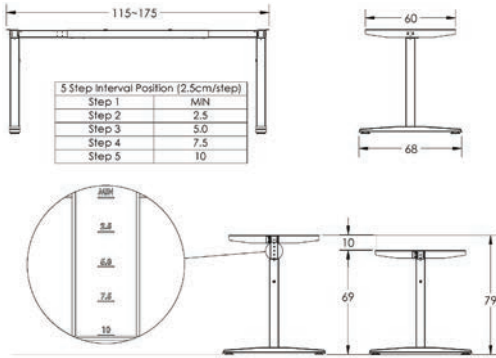

SD 215

Fix Height



Fix Height Desk Frame | Fix Height



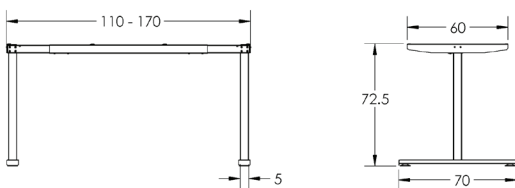

Height (mm)	725
Frame Length (mm)	min. 1100/ max. 1700
Dynamic Weight Capacity (kg)	150
Frame Weight (kg)	~13
Carton Size (cm)	L96 x 26 x H11.5
Pallet Size (cm)	L110 x W90 x H110



SPECIAL USE LIFTING COLUMNS







SSL01

 Load Capacity (N)	 Speed (mm/s)	 Stroke (mm)
1500	15	100-500
 Height (mm)	 Section Size (mm)	
Stroke+360	100 x 50	







SSL02

 Load Capacity (N)	 Speed (mm/s)	 Stroke (mm)
3500	6	430
 Height (mm)	 Section Size (mm)	
695-1125	196 x 148	



SSL03

 Load Capacity (N)	 Speed (mm/s)	 Stroke (mm)
600	380	640
 Height (mm)	 Section Size (mm)	
560-1050	70x70/ 60x60 / 50x50	

Handsets Controls



SDH01

- Up Down Button
- Easy to use



SDH02

- 4 Memory Buttons
- With LED
- With USB



SDH03

- 4 Memory Buttons
- Piano Style
- With LED



SDH04

- Up Down Button
- With Screen



SDH05

- 3 Memory Buttons
- Touch Screen
- With USB



SDH06

- Pedal Type
- Woodgrain / Black
- With Screen



SDIH01

- 4 Memory with Screen
- Integrated System
- USB Type B



SDIH02

- Up Down Buttons
- Integrated System



SDH07

- Embedded Type
- Touch Screen
- LED Display

Control Box



SDC01

- 1 Motor Control
- 32V DC, 6A
- Built In Sensor
- 0.1 Standby Power



SDC02

- 2 Motor Control
- 32V DC, 10A
- Built In Sensor
- 0.1 Standby Power



SDC03

- 3 Motor Control
- 32V DC, 10A
- Built In Sensor
- 0.1 Standby Power

Accessories



Power Adapter

- For Integrated System
- SMPS Transformer
- 29V DC, 3A
- UL,PSE,SAA



RF Remote Control

- For 1-3 Motors
- 2 Buttons
- 5m Range Control
- LED Indicator



Electric Module

- For Power Module
- 2 Buttons
- 1-5 Gang
- CCC,PSE,KC



Backup Power

- Work as Power Source
- Lithium Battery
- 2.5Ah/63Wh
- Max Output : 15A

FOOT SERIES



SDF001

- Bridge Design
- 680 x 70mm



SDF002

- Flat Bend
- 700 x 70mm



SDF003

- Flat Foot
- 700 x 70mm



SDF004

- Bridge Curve
- 730 x 70mm



SDF005

- 70mm Hole
- 750 x 90mm

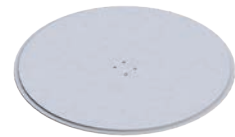

SDF006

- Round Base
- Ø 450



CB440

- Sleeve Cover
- L592 x W76 x H520



SD-SC01

- Cover Box
- L710 x W70 x H630

COLOURS

MULTIPLE HYBRID POWDER COATED COLOUR CHOICES

We are using hybrid powder that compliances to RoHs. and are tested to ensure the powder is firmly coated.

Classic Colours (Texture Finishes)



RAL 9016
D1
Glossy White



RAL 9010
W1
Texture White



RAL 9004
B1
Texture Black



RAL 9005
B2
Matte Black



RAL 7045
S1
Texture Silver



RAL 9003
W2
T.White



RAL 9005
W6
M. Warm White



RAL 7043
G1
T.Light Grey



RAL 7043
G3
T.Dark Grey



RAL 3020
R1
T. Traffic Red

OUR COLUMNS



SSQ2-01

- 2 Tiers Square
- 50x50; 60x60



SRC2-01

- 2 Tiers Rectangle
- 80x50; 70x45



SRD2-01

- 2 Tiers Round
- Ø 70; 63.5



SSQ3-01

- 3 Tiers Square
- 50x50; 60x60; 70x70



SRC3-01

- 2 Tiers Rectangle
- 80x50; 75x45; 70x40



SRD3-01

- 3 Tiers Round
- Ø 70; 63.5; 57

SUNDeSK[®]

Ergonomic Height Adjustable Desk Solution

sundeskventure.com